

# Assembly drawing for the Product Return Elbow

FILE NAME : PRV2E45

No	Part Number	Qty
1	PRV2E45-AMC	1
2	PRV2NRVPOP	1
3	SPR1606	1
4	SPR1610	1
5	G150-V	1
6	AIR1609	1
7	VAL1608-V	1
8	AIR1659	1

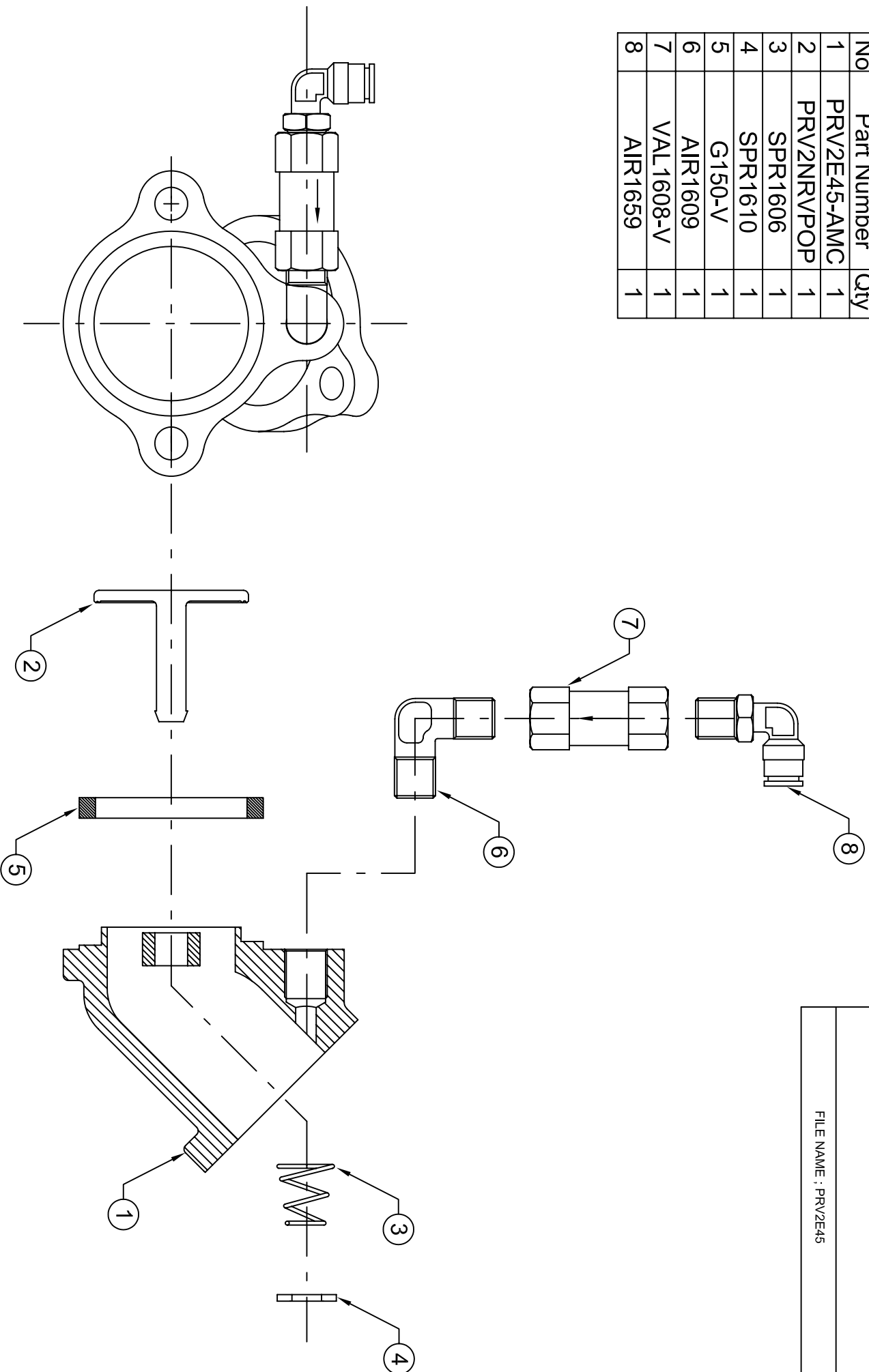

**Assembly Notes:**

1. Insert the Elbow AIR1609 First
2. Make sure the seal has been changed to a viton seal in the check valve, and is also stamped with a V
3. For a 15° Elbow assembly just replace the 45° with a 15°.